

PRIOR TO INSTALLATION

Due to its large size, several aspects should be taken into account before installation.

1. Check the route to where the panels are to be placed, to make sure that the path is wide enough for two people can carry the panel to where it is being installed.
2. Kobert-In cannot be installed outdoors. When in doubt, check with the manufacturer.
3. Review all the information on the technical sheet to know if the product meets the appropriate requirements of the place where you want to install.
4. Establish a wide and safe workspace to be able to manipulate the panels (cut, glue, etc.).

EQUIPMENT & MATERIALS TO INSTALL KOBERT-IN PANELS

1. Table saw/Circular saw with cutting guide. Cutting guide must be long enough to cut the length of the panel. Circular saw blade should be suitable for cutting aluminum.
2. Rubber trowel to apply grout material between panels
3. Sponge to clean excess grout
4. Electric drill is only necessary if you need to make holes for electrical outlets, light switches, faucet openings etc. A quick cutting steel drill bit is recommended.
5. Wide masking tape to protect edges of panels from excess grout.
6. Sandpaper #120
7. Quick Grab, Heavy Duty (non-solvent based) Construction Adhesive. Use Silicone Adhesive when installing panels over existing tile.
8. Grout to fill in seams.

TRANSPORTATION & HANDLING

1. Upon opening the package/pallet, before you handle the panels, make sure they are in good condition.
2. Carry the Kobert-In panels as individual pieces using two people. **(Figure 1)**
3. Avoid setting the panels on the floor by the corners, always try to set the panels down on the flat edge and support it with something soft like wood or rubber that will avoid scratches.
4. Wear protective gloves when handling the panels.
5. Transport the panels perpendicular to the ground.
6. Select an open and safe work area as close as possible to the installation location.
7. When cutting the panels be sure that the height of the cutting table is at a comfortable level for the installers to ensure precision cuts.

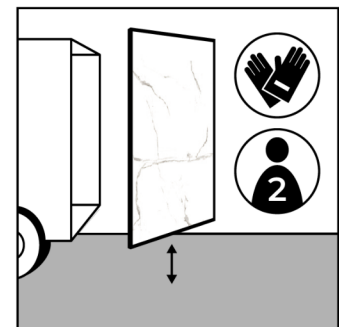

Figure 1

RECOMMENDATIONS

1. Check the flatness of the wall you are installing the panels on using a five foot long level. The maximum allowable tolerance is 1/8 inch, anything more should be filled with some filler material that is fixed to the wall to even it out. **(Figure 2)** Also check that the wall surface you are installing onto is dry and free of moisture. Clean all dust, grease or any other substance that may compromise the adhesion of the panel to the wall.
2. Be aware of the sequence of the panel designs. In most cases, the pattern you have selected comes in 5 different variations, these are always arranged in order of 1 to 5 during production, however they may not be in that order when they are packaged. All panels have a small watermark on the upper left edge where you determine which panel is to follow the recommended order of installation. We recommend you make a small numbering scheme using the watermarks to follow as opposed to visually looking at the panel designs. **(Figure 2)**

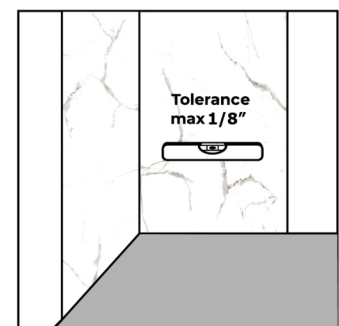

Figure 2

APPLY THE ADHESIVE

1. First place the panel on the work table with the non-printed side up, remove the protective film, apply the recommended adhesive taking into account that the bead should be no less than 1/8 inch thick, this can be controlled by the diameter of the hole in the cartridge applicator. **(Figure 3)**
2. The adhesive should be placed around the perimeter of the panel on all four sides at about 1 inch from the edge. Then apply vertical beads up and down the length of the panel at about 4 inches apart. **(Figure 3)**

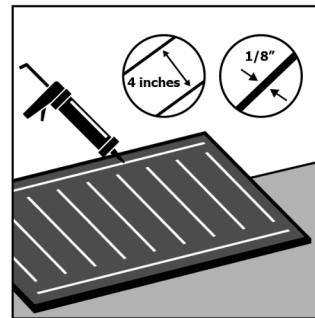

Figure 3

INSTALL THE PANEL

Place the panel against the wall with the adhesive side toward the wall. The adhesive will allow you to make positioning adjustments for 15-20 minutes. This time varies based on the humidity within the room where it is being installed. High humidity reduces the time and low humidity increases the time.

REVIEW

1. To cut the panels you must use a circular saw and recommended blade. **(Figure 5)** The cutting operation should always be done with the printed/decorated side up. Before making the cut, fix the cutting guide to the panel using pressure clamps, we recommend the use of a square to ensure that the cut is straight.
2. Once the cut is made, carefully sand the cut edge with sandpaper to smooth it out.

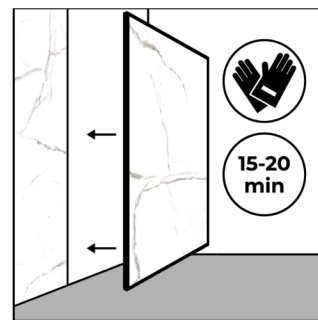

Figure 4

GROUTING THE SEAMS

Once all the panels have been installed, you will place masking tape along the vertical edges of the panels, butting up to the space where the grout will go. **(Figure 6)** This will help reduce the extra grout you have to sponge off by allowing you to simply peel the tape off later. After taping, apply the grout to the seams using a rubber trowel.

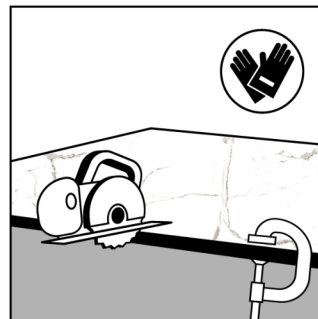

Figure 5

CONTROL THE TIME

20 minutes after the grout is applied, you can begin to clean the excess grout off with a damp flat sponge. Important: The cleaning off of excess grout should not be delayed, as the grout dries, the harder it gets and the more difficult it is to remove. **(Figure 7)**

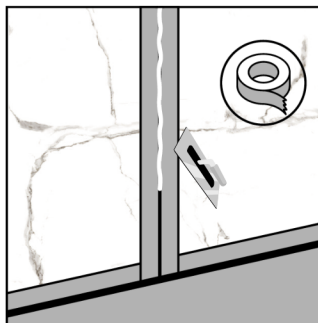

Figure 6

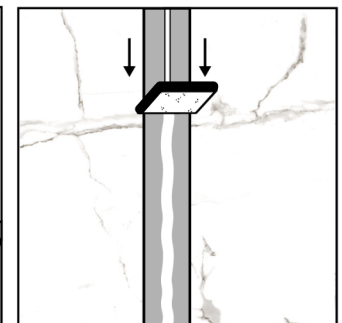

Figure 7



Installation
video